

# Single Mode Multi Fiber Collimator

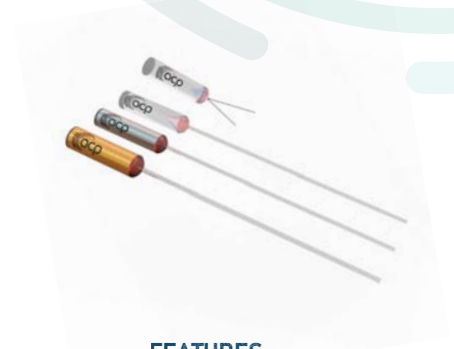

## PERFORMANCE SPECIFICATIONS

Parameter	Specifications			
Operating Wavelength	1310±30, 1550±30, 1310/1550±30 or 980/1550±30nm			
Number of Fiber	Dual Fiber		Multi Fiber	
Grade	P	A	P	A
Transmission	0.20 Typ. <sup>1)</sup>	0.30 Typ. <sup>1)</sup>	0.30 Typ. <sup>1)</sup>	0.40 Typ. <sup>1)</sup>
Insertion Loss (dB)	≤0.28 Max.	≤0.40 Max.	≤0.40 Max.	≤0.50 Max.
Reflection Loss	≤ 0.28dB <sup>2)</sup>	≤ 0.40dB <sup>2)</sup>	≤ 0.40dB <sup>2)</sup>	≤ 0.50dB <sup>2)</sup>
Between Two Fibers (dB)				
Return Loss	≥ 60dB	≥ 60dB	≥ 60dB	≥ 60dB
Beam Diameter	≤ 0.45 (Φ1.8mm Lens) ≤ 0.35 (Φ1.0mm Lens)		≤ 0.50mm	
Operating Temperature	- 20 to +75°C			
Storage Temperature	- 40 to +85°C			
Package Dimensions	Φ1.8(OD) Lens (Standard):  A=4x10mm Gold plated SS tube B=3.2x10mm Gold plated SS tube C=2.4x10mm SS tube (Gold plated optional) D=2.78x10mm Glass tube or custom size  Φ1.0(OD) Lens (Min-size):  E=2.8x10mm SS tube (Gold plated optional) F=2.0x7mm Glass tube G=1.4x6mm Gold plated SS tube H=1.2x7mm Glass tube		Φ1.8(OD) Lens (Standard):  B=3.2x10 Gold plated SS tube C=2.4x10 SS tube (Gold plated optional) D=2.78x10 Glass tube or custom size	

### Note:

1) At 10mm working distance and single wavelength. Dual wavelength IL will increase by 0.1dB.

2) At < 1mm reflection working distance (RWD) and single wavelength with 100% reflection mirror.

All values referenced are without connector.

## FEATURES

- Low Insertion loss
- Low Back Reflection
- High Environmental Stability
- Wide Operating Wavelength
- Compact Size
- Excellent Environmental
- Mechanical Stability

## APPLICATION

- Fiberoptic Lab Use
- Laser Beam Collimating
- Fiber to Fiber Coupling
- Local Area Networks
- CATV Systems
- Subscriber Loop
- Fiberoptic Instruments

## Single Mode Multi-Fiber Collimator

### MECHANICAL DIMENSIONS

Package A/B/C/D

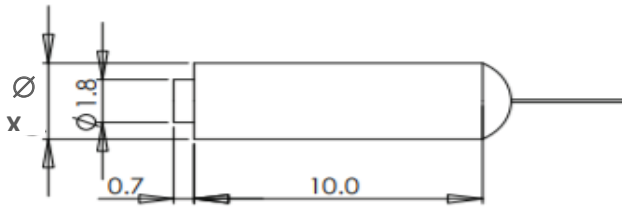

X=4.0/3.2/2.4/2.78mm

Package E

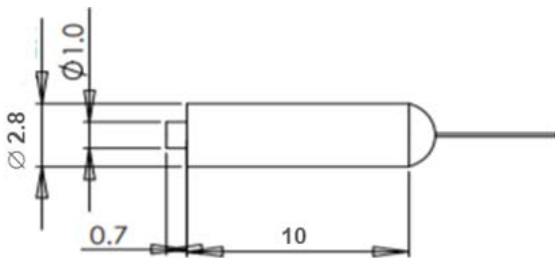

Package G

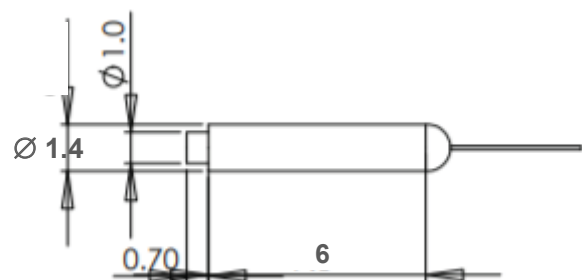

Package F/H

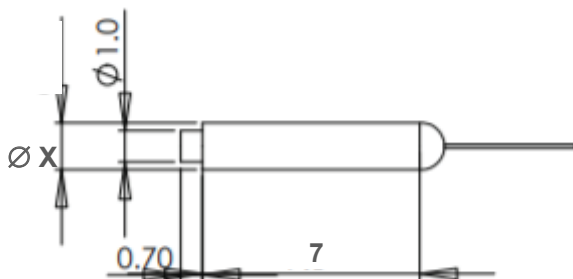

X=2.0/1.2mm

## Single Mode Multi-Fiber Collimator

### PORT CONFIGURATION



### ORDERING INFORMATION

CL	Number of fibers	Grade	Operating Wavelength	Direction	Working Distance (WD)	Package	Fiber Type*	Pigtail Style <sup>1)</sup>	Fiber Length	Connector
2=Two	P=P grade	31=1310nm	T=Transmission	01=1mm	A=4.0x10mm	2=SMF-28 Ultra	1=Bare fiber	05=0.5m	0 = None	
3=Three	A=A grade	55=1550nm	R=Reflection	02=2mm	B=3.2x10mm	(G.657.A1)	2=900um loose tube**	10=1.0m	1 = FC/APC	
4=Four		35=1310/1550nm		.	C=2.4x10mm	3=ClearCurve		.	2 = FC/PC	
S=Custom		95=980/1550nm		.	D=2.78x10mm	ZBL(G.657.B3)	6=900um tight buffer	.	3 = SC/APC	
				.	E=2.8x10mm			.	4 = SC/PC	
				70=70MM	F=2.0x7mm			50=5.0m	5 = ST	
					G=1.4x6mm				6 = LC/UPC	
					H=1.2x7mm				7 = LC/APC	

1) 1.6mm or 2mm jacket is also available upon request.

\*1=SMF-28(G.652) is available upon request.

\*\*Available fiber length is up to 2m.